

WHEN DISASSEMBLING ALUMINUM EXTRUSION, TIGHTEN ALL SETSCREWS AND LOCKS TO PREVENT LOSS DURING SHIPPING

visionary™ DESIGNS

Using Your Setup Instructions

The Visionary Designs Setup Instructions are created specifically for your configuration. They are laid out sequentially, including an exploded view of the entire display, and then a logical series of detailed steps to assemble the main structure and components. We encourage you to study the instructions **before** attempting to assemble your exhibit.

Each page reminds you to tighten the setscrews after disassembling your exhibit to prevent loss of the locks and setscrews (see below in RED). This is **VERY IMPORTANT**.

Cleaning and Packing Your Display

- 1) Use care when cleaning aluminum extrusion or acrylic inserts. Use only non-abrasive cleaners.
- 2) When cleaning laminate inserts or countertops, use mild cleansers and a soft material such as cotton.
- 3) Keep all display components away from extreme heat and long exposure to sunlight to avoid warping and fading.
- 4) Retain all packing material. It will make re-packing much easier and will reduce the likelihood of shipping damage.



The Tool

Most Visionary Designs exhibits can be assembled with the supplied Hex Key Tool. Occasionally, a flat head screwdriver may be required.



Typical Connection

Most horizontal extrusion connections have a patented expandable lock. This lock inserts into the groove of an opposing extrusion. Tightening the lock with the Hex Key Tool expands the lock and creates a strong positive connection.



Typical Connection (cont'd)

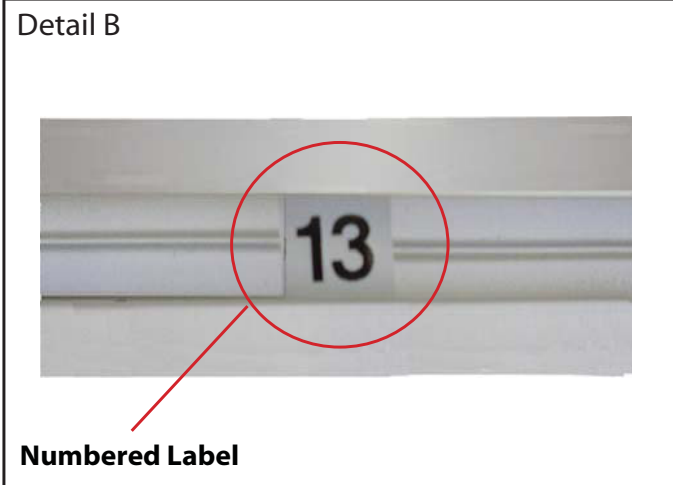

Numbered Label

Each extrusion contains a numbered label which corresponds with setup instructions. The label is located within a groove of the extrusion (when possible). With Visionary Designs the labels contain Black numbers unless otherwise specified.



Horizontal Inline Connection (remove only one setscrew)

Remove only (1) setscrew when disassembling. Replace setscrew in extrusion after assembling it. Before packing, replace setscrew in extrusion to avoid losing it.

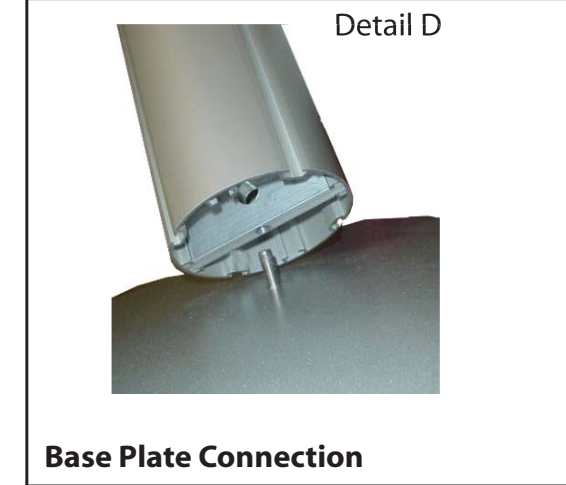

Base Plate Connection

Attach base plate to round or square vertical extrusion using the bolt provided. Be careful not to strip the threads.

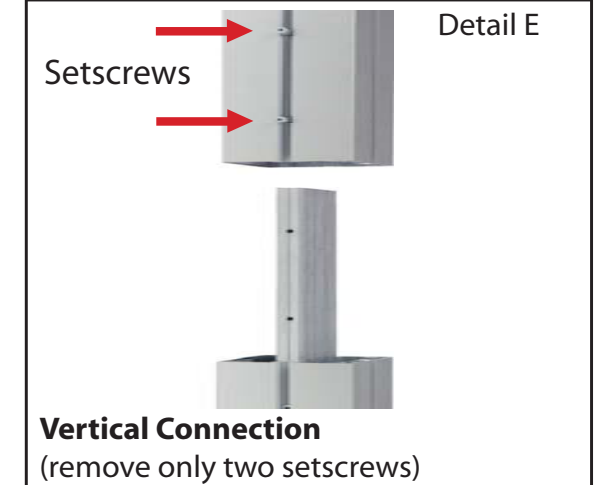

Vertical Connection
(remove only two setscrews)

When vertical extrusions are packed in portable cases rather than crates or tubs, they must be broken down into smaller sections which then require assembly.

Remove only (2) setscrews when disassembling. Replace setscrews in extrusion after assembling it. Before packing, replace setscrews in extrusion to avoid losing them.

WHEN DISASSEMBLING ALUMINUM EXTRUSION, TIGHTEN ALL SETSCREWS AND LOCKS TO PREVENT LOSS DURING SHIPPING

866.652.2100

Item	Quantity	Description
1	3	Round Basseplate
2	2	48" h Round Vertical Extrusion
3	2	48" h Round Vertical Extrusion
4	1	48" h Round Vertical Extrusion w/permanent S10
5	1	48" h Round Vertical Extrusion w/permanent S10
6a	1	47.473" Lower Curved Horizontal Extrusion
6b	1	47.473" Lower Curved Horizontal Extrusion
7a	1	47.473" Upper Curved Horizontal Extrusion
7b	1	47.473" Upper Curved Horizontal Extrusion
8	1	29" Lower Extrusion
9	1	29" Upper Extrusion

Steps:

- 1) Assemble 48" h Lower and Upper Vertical extrusions [part: 2 to part: 3] and [part:4 to part: 5] to make 96" h Vertical Extrusions.
- 2) Assemble all Horizontal curved extrusions [parts: 6a to 6b and parts: 7a to 7b].
- 3) Attach 96" h Vertical extrusions [part: 2/3] to the Base plates [part:1].
- 4) Attach Lower Horizontal assemblies [6a/6b] to both 96" h Vertical assemblies [parts: 2/3 & parts 4/5].
note: Velcro on Lower Horizontals must face UP.
- 5) Attach Upper Horizontal assemblies [7a/7b] to both 96" h Vertical assemblies [parts: 2/3 & parts 4/5].
note: Velcro on Upper Horizontals must face DOWN.
- 6) Attach Lower Horizontal Part [8] to both 96" h Vertical assemblies [parts: 4/5 & parts 2/3].
note: Velcro on Lower Horizontals must face UP.
- 7) Attach Upper Horizontal Part [9] to both 96" h Vertical assemblies [parts: 4/5 & parts 2/3].
note: Velcro on Upper Horizontals must face DOWN.

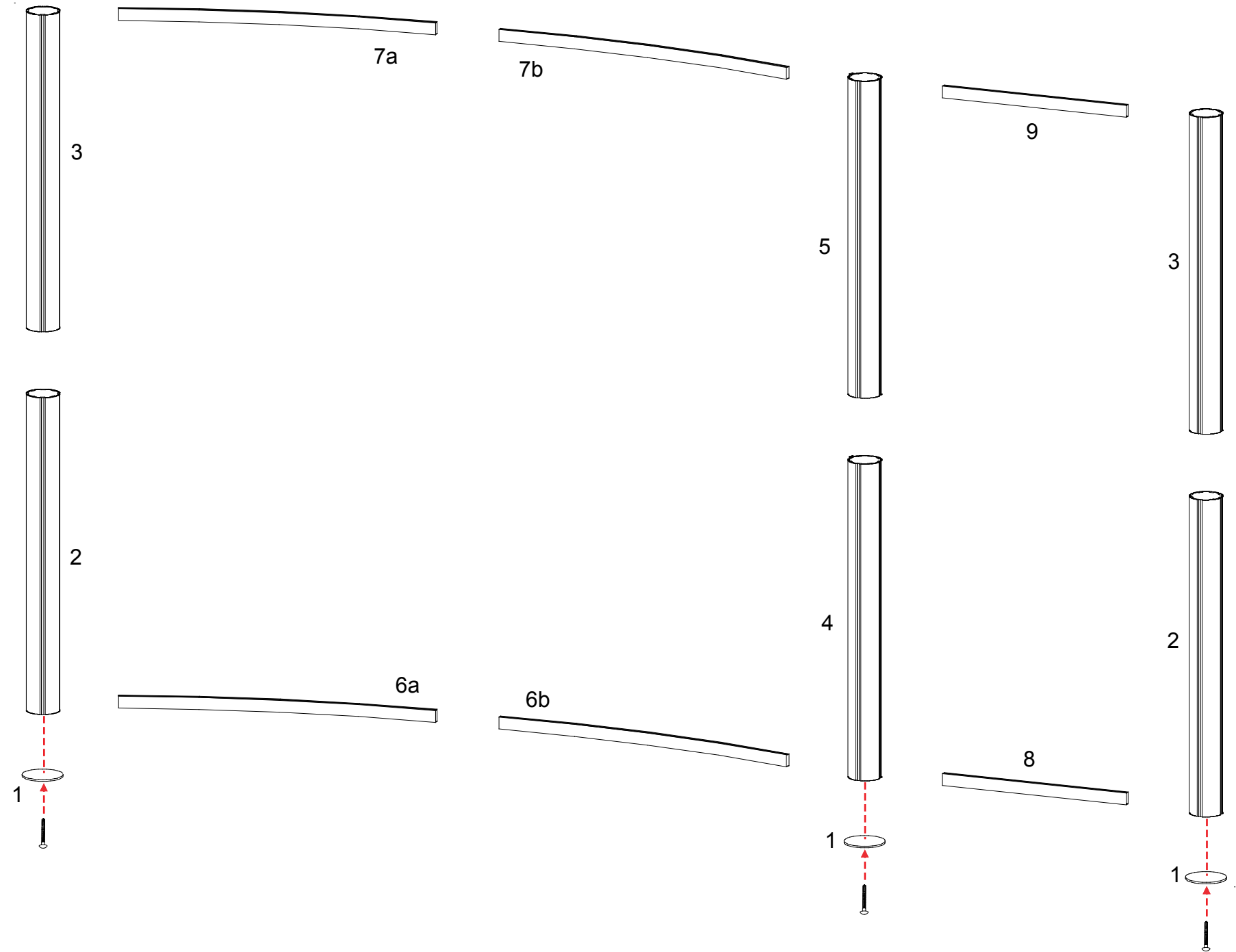

WHEN DISASSEMBLING ALUMINUM EXTRUSION, TIGHTEN ALL SETSCREWS AND LOCKS TO PREVENT LOSS DURING SHIPPING

866.652.2100

Item	Quantity	Description
1	1	Round Basseplate
2	1	48" h Round Vertical Extrusion
3	1	48" h Round Vertical Extrusion
8a	1	44.506" Lower Curved Horizontal Extrusion
8b	1	44.506" Lower Curved Horizontal Extrusion
9a	1	44.506" Upper Curved Horizontal Extrusion
9b	1	44.506" Upper Curved Horizontal Extrusion

Steps

- 1) Assemble 48" h Lower and Upper Vertical extrusions [part: 2 to part: 3] to make 96" h Vertical Extrusions.
- 2) Assemble all Horizontal curved extrusions [parts: 8a to 8b and parts: 9a to 9b].
- 3) Attach 96" h Vertical extrusion [part: 2/3] to the Base plate [part:1].
- 4) Attach Lower Horizontal assemblies [8a/8b] to both 96" h Vertical assemblies [parts: 2/3 & parts 4/5].
note: Velcro on Lower Horizontals must face UP.
- 5) Attach Upper Horizontal assemblies [9a/9b] to both 96" h Vertical assemblies [parts: 2/3 & parts 4/5].
note: Velcro on Upper Horizontals must face DOWN.
- 8) See next page for Canopy Assembly and Set up instructions.

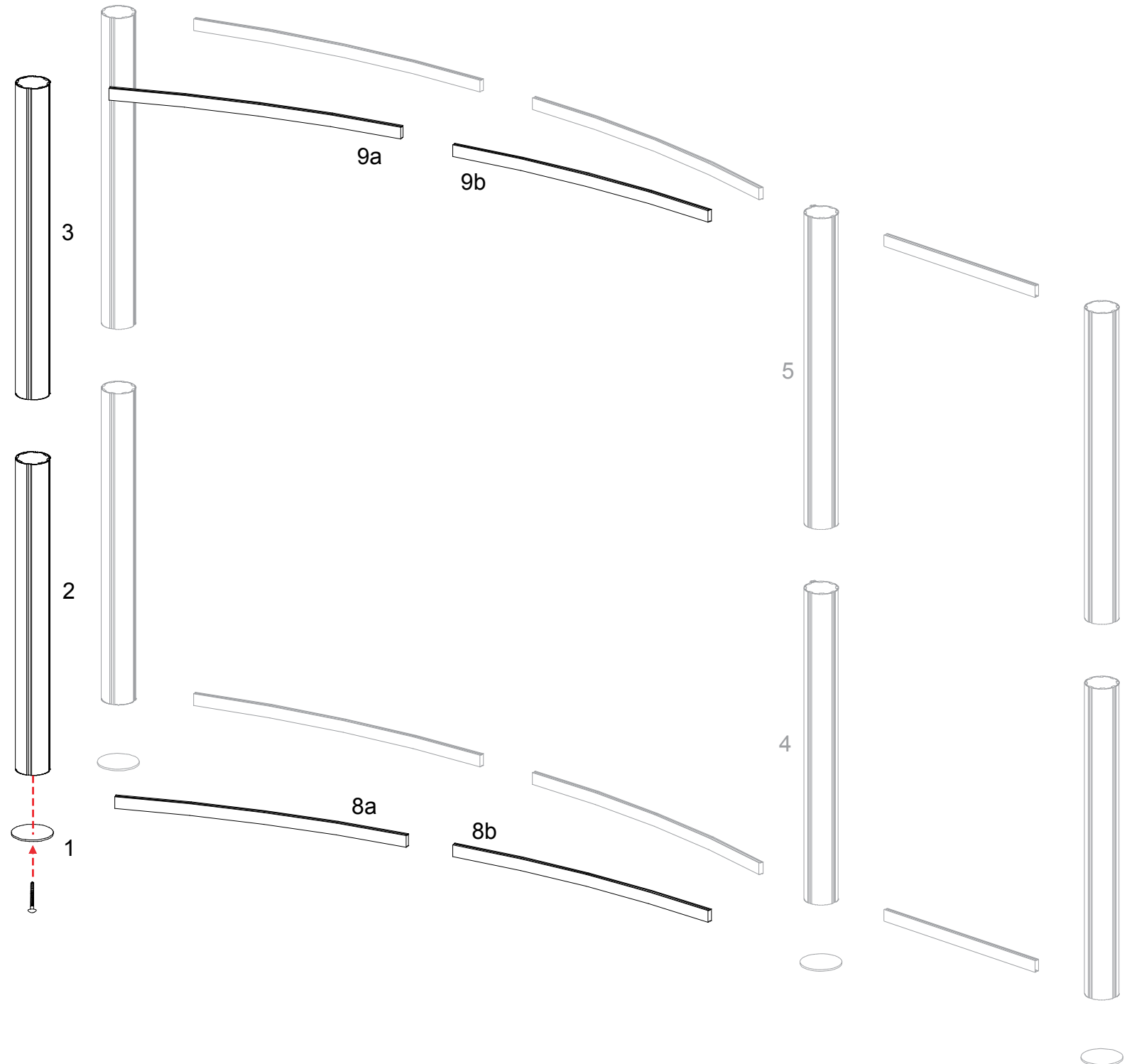

WHEN DISASSEMBLING ALUMINUM EXTRUSION, TIGHTEN ALL SETSCREWS AND LOCKS TO PREVENT LOSS DURING SHIPPING

866.652.2100



Using Your Setup Instructions

The Aero Overhead Sign Setup Instructions are created specifically for your configuration. They include an exploded view of the frame which is sequentially numbered. We encourage you to study the instructions before attempting to assemble your exhibit.

Connections are kept very simple: no tools. Everything assembles with push-button connectors and pre-connected horizontal sections.

Cleaning and Packing Your Display

- 1) Use care when cleaning aluminum extrusion or acrylic inserts. Use only non-abrasive cleaners.
- 2) Retain all packing material. It will make re-packing much easier and will reduce the likelihood of shipping damage.

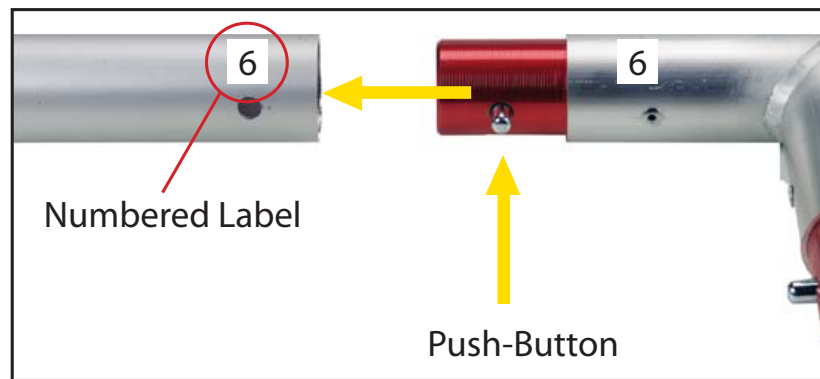
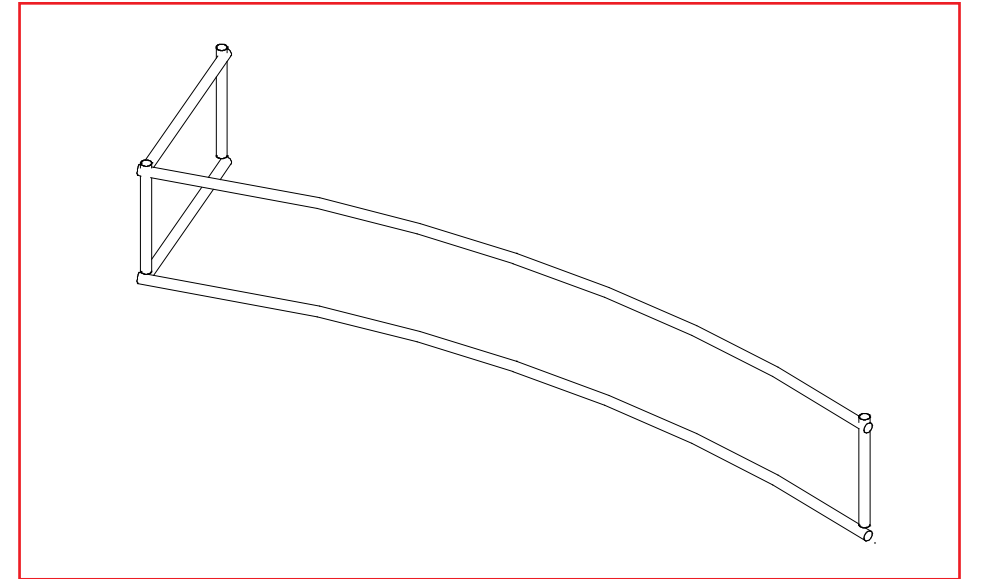

Connections are made by holding the button down and sliding the red tube into opposing tube until the connection is made. To disassemble push button and pull or twist extrusions apart.

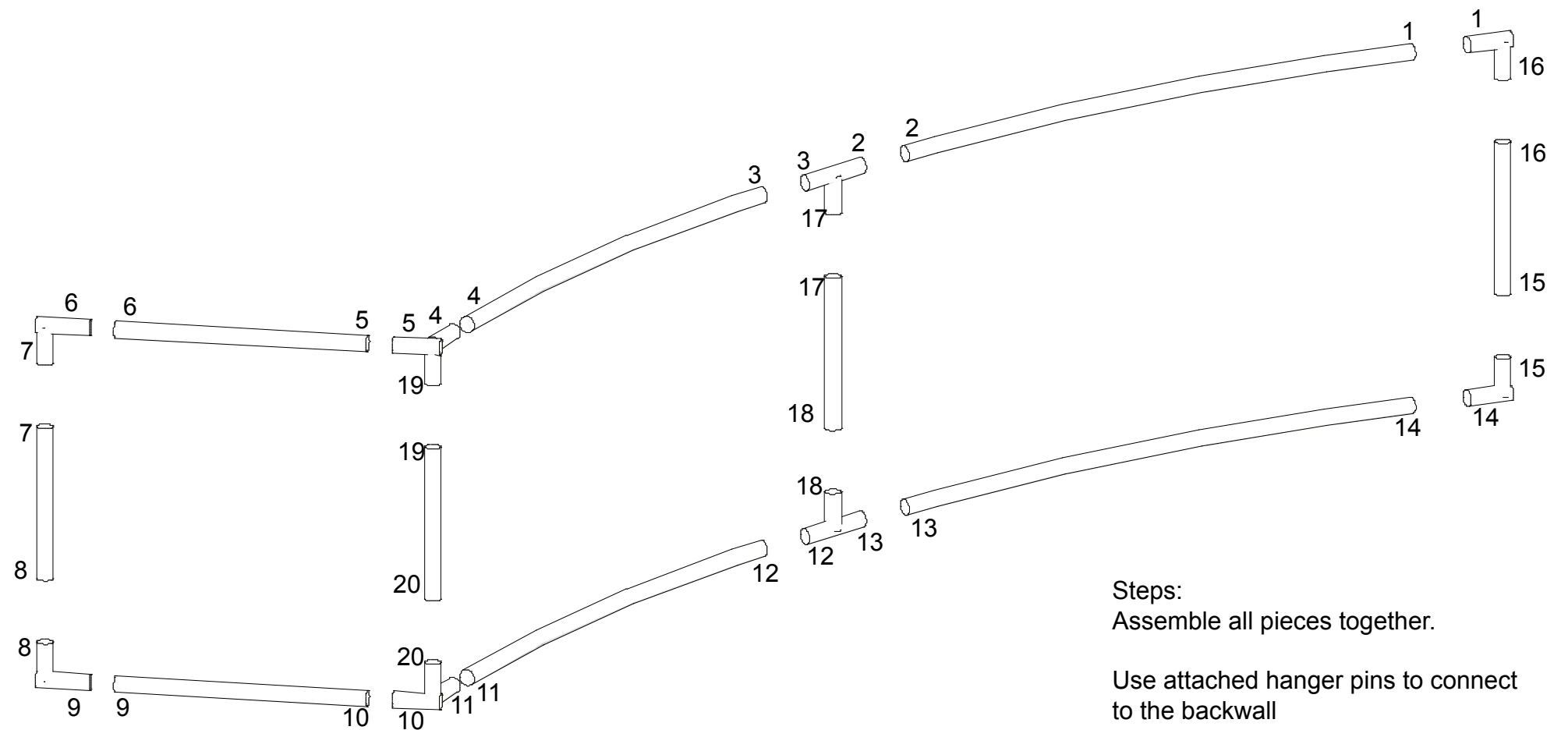
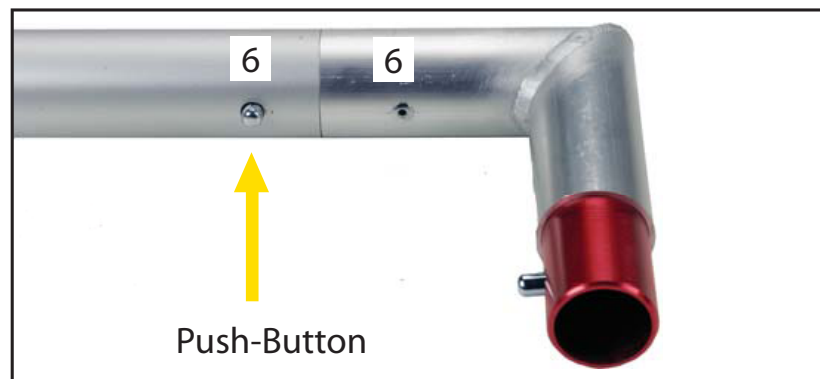

Steps:
Assemble all pieces together.

Use attached hanger pins to connect to the backwall

WHEN DISASSEMBLING ALUMINUM EXTRUSION, TIGHTEN ALL SETSCREWS AND LOCKS TO PREVENT LOSS DURING SHIPPING